



# [promultis] touch screen



 [promultis]

the sleek all-in-one touch screen solution

## USER'S MANUAL

### CAUTION

- Changes or modifications not expressly approved by the party responsible for compliance could void the user's authority to operate the equipment.
- This User's Manual includes detailed usage instructions for your product.
- Please read this manual thoroughly.
- Figures and illustrations in this User Manual are provided for reference only and may differ from actual equipment appearance. Equipment design and specifications may be changed without notice.



# CONTENTS

Getting started	1
Unpacking	1
Viewing the control panel	2
Viewing the connection panel	3
Viewing the remote control	4



# GETTING STARTED

## Unpacking

The following items are included in your product box.



Promultis Touch Screen

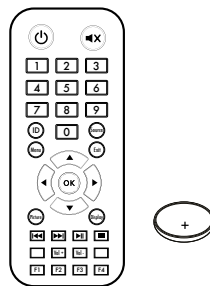

Remote Control with Battery

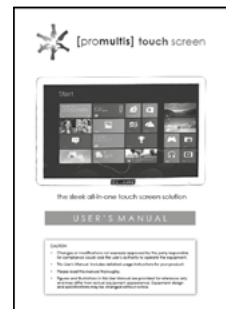

Promultis Manual

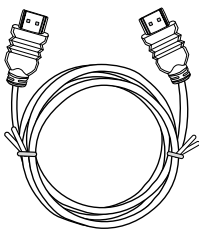

HDMI Cable



AC Power Supply

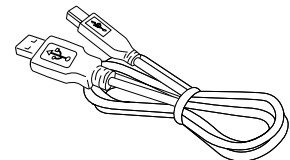

USB Cable



# GETTING STARTED

## Viewing the connection panel

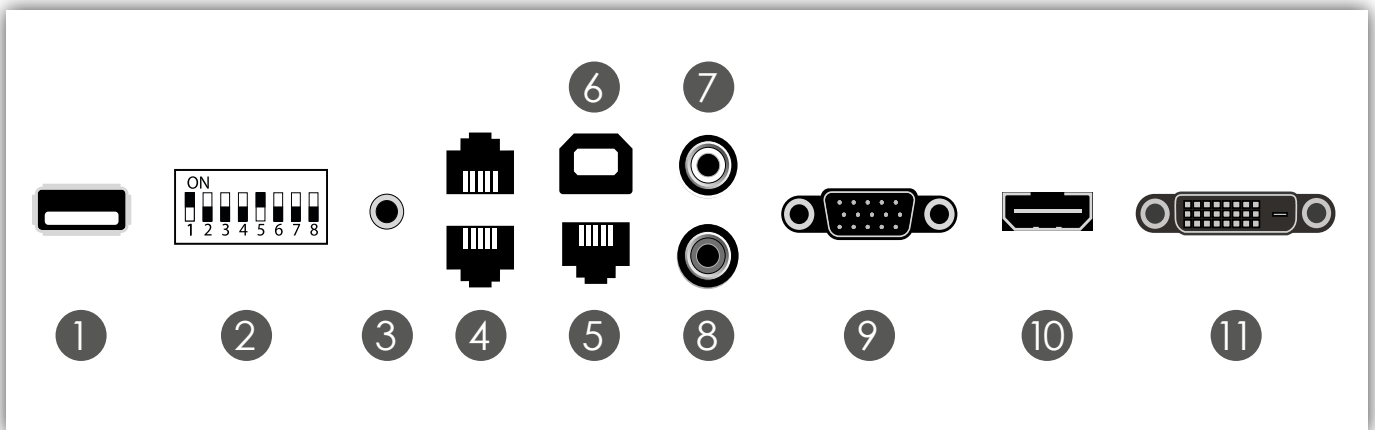

1	USB	7	AV Input
2	Dip Switch	8	AV Output
3	PC IR Extention (not needed)	9	VGA Input
4	Serial port input	10	HDMI Input
5	Audio	11	DVI Input
6	ISP		



# GETTING STARTED

## Viewing the remote control

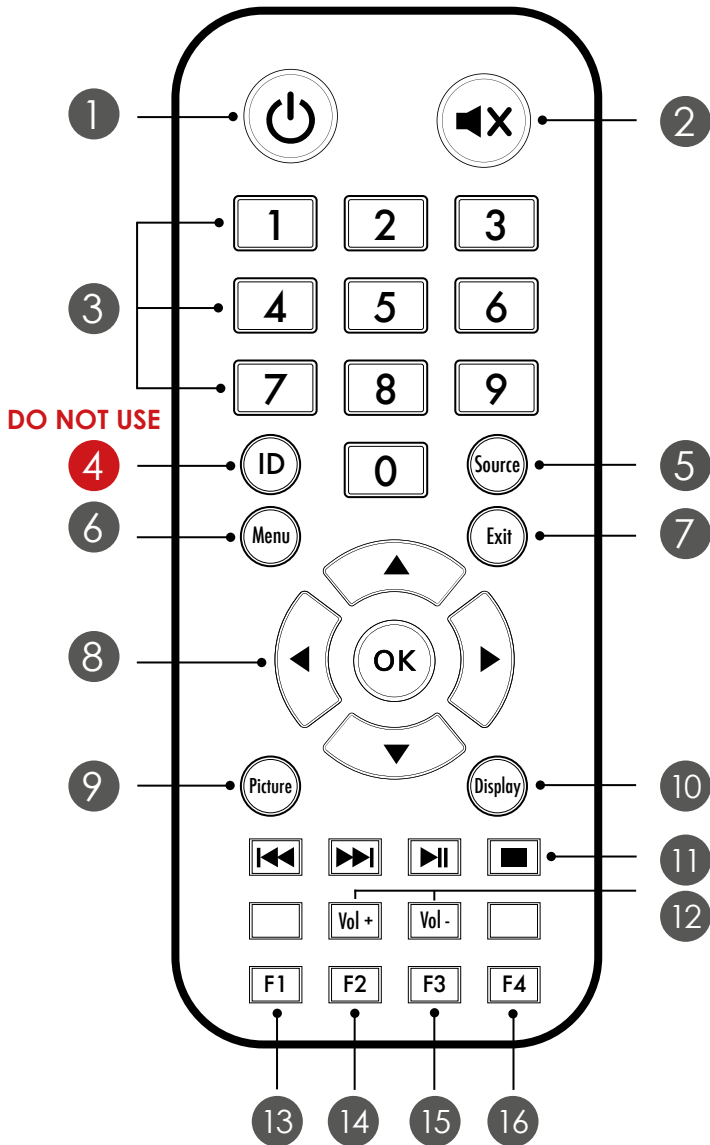

1	<b>Power</b> Press to tum me IU on and off
2	<b>MUTE</b> Press to temporarily switch the sound off
3	<b>CHANNELS</b> Change channel inputs
4	<b>ID (Screen Identification)</b> <b>DO NOT PRESS AS THIS WILL DISABLE ALL REMOTE FUNCTIONS*</b>
5	<b>SOURCE/ AV/ INPUT</b> Press all to display a menu of all available input sources
6	<b>MENU</b> Press to display the on-screen menu
7	<b>EXIT</b> Press to close current menu
8	<b>OK</b> Press to accept your selection or display the current mode  Press to select on-screen menu items or change menu values
9	<b>Picture</b> Change picture setting, user, high brightness, standard, sport, cinema
10	<b>Display</b> Model info on screen
11	<b>REWIND/FORWARD/PLAY/PAUSE/STOP</b> Able to rewind, forward,play, pause and stop the screen
12	<b>Vol+ / Vol -</b> Press to increase or decrease the volume
13	<b>F1</b>
14	<b>F2</b>
15	<b>F3</b>
16	<b>F4- FREEZE</b> Press to freeze the picture and doesn't pause PC

\* If enabled turn off screen manually to reinitiate the remote control