

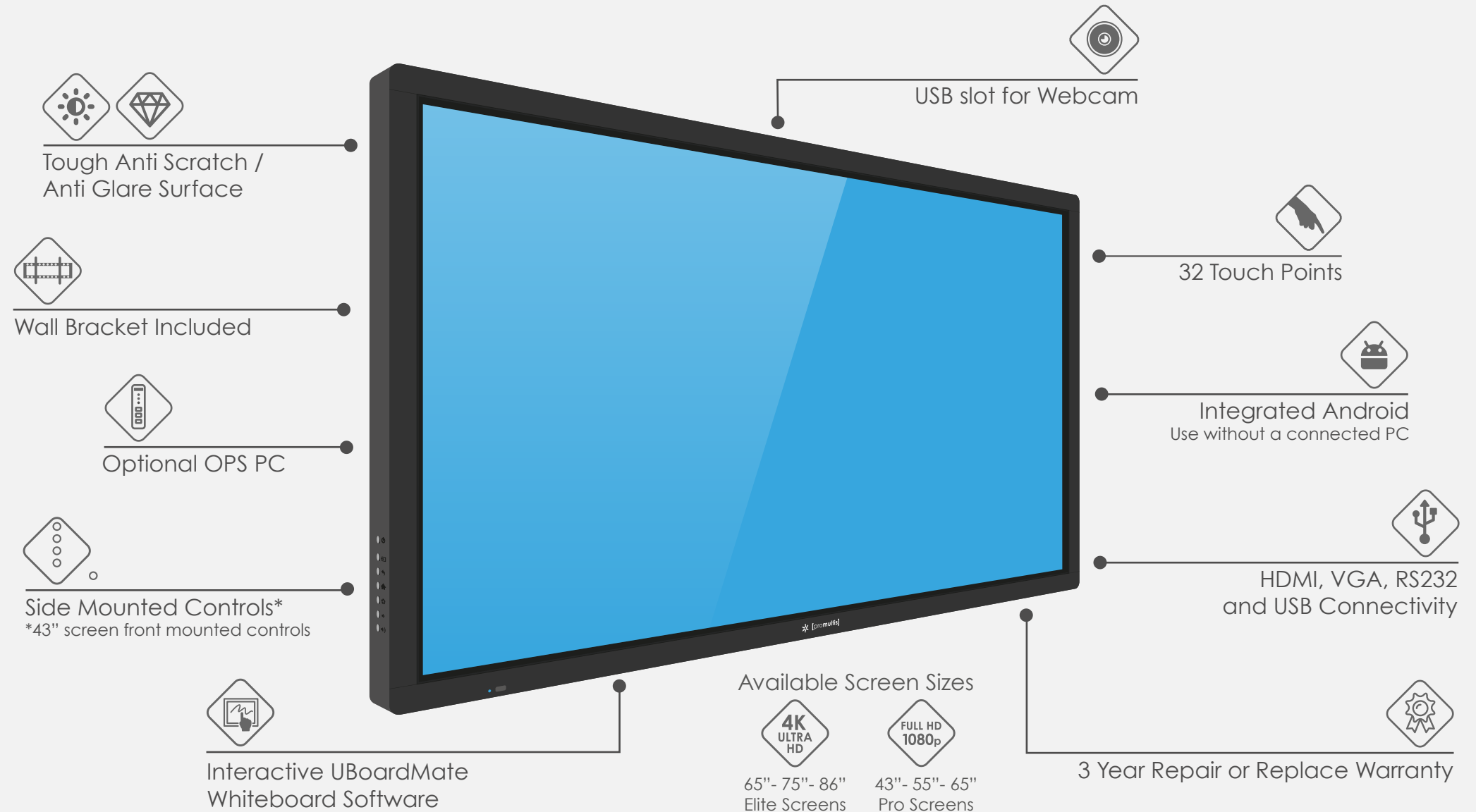

**[promultis]**

# Lightning II Touch Screen

Offering Full HD 1080p or 4k, the picture quality is excellent and the touch response is superb. The screen is perfect for Business, Education and Commercial use.



**The Promultis Lightning II is a highly versatile, fast and reliable multitouch screen. With a narrow bezel and modern sleek design, this unit is extremely well equipped with the latest in multitouch infra-red technology.**

Available in sizes from 43" up to 86" and available in 1080p HD or 4K UHD variants. The wall or stand mounted Lightning II screen is a very flexible and highly cost-effective solution to a multitude of needs.

Promultis Touch Screens are ideal for:

- Control rooms
- Interactive digital signage
- Education and training rooms
- Presentation environments
- Video conferencing
- Boardrooms
- Reception area



### Integrated Android 5.01

Connect a usb drive to one of the usb ports on the display and upload your media directly into the built-in Android Operating System. View and manage your media assets directly from the usb drive.

In addition, you can open the Play Store and install any app onto the screen.

### Onscreen Menu



Onscreen menu allows you to change volume, change video input, freeze the screen, annotate, and turn off the screen. These options are also accessible from the buttons on the side of the screen.

### Optional PC integration in rear of display

OPS PC with Intel i5 or i7 Processor and built-in A/C band WiFi Router.



### USB port for camera

USB port on the top of the display for usb web camera, allowing you to use the Lightning II as a very powerful video conferencing tool and take advantage of a whole host of photo and video applications.



*In this example Promultis developed interactive software to exploit the screen webcam feature allowing the client's employees to upload their photograph and add a message of support for an on-going product development.*

### Promultis White Board Software

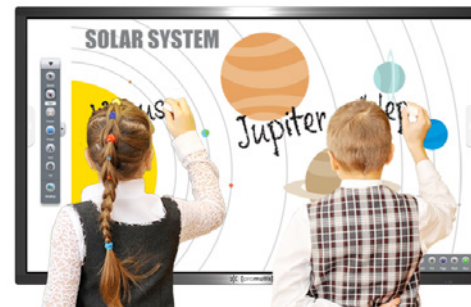

The Lightning II also comes with our industry renowned UboardMate interactive whiteboard software, which allows you to interact with the screen content in a multitude of fun and creative ways, perfect for education and training.

### Optional Collaboration Software

Promultis software solutions help you to make presentations more interactive. Allowing your audience to connect wirelessly and contribute to your presentation and collaborate with each other from their own devices. Participants can contribute, add their own notes, capture content and save that session for review at a later date. Enhance meetings, presentations, training and teaching.

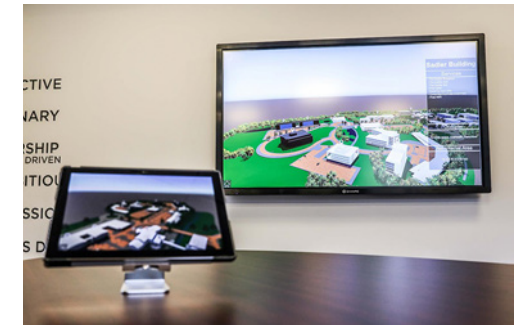

### Optional Bespoke Interactive Software

Engage with customers through a fully branded, interactive application with multi-user, collaborative interface incorporating your corporate identity, images, literature, audio files, videos, web sites and social media.



*Interactive, digital signage solution developed for a city centre transport hub in Scotland featuring wayfinding, local attractions and transport timetables.*

|                           | 43" Lightning II Pro  | 55" Lightning II Pro  | 65" Lightning II Pro  | 65" Lightning II Elite | 75" Lightning II Elite | 86" Lightning II Elite |
|---------------------------|-----------------------|-----------------------|-----------------------|------------------------|------------------------|------------------------|
| <b>Dimensions</b>         |                       |                       |                       |                        |                        |                        |
| Width                     | 1013.5 mm             | 1311 mm               | 1527 mm               | 1527 mm                | 1749 mm                | 2007 mm                |
| Height                    | 614 mm                | 783 mm                | 903 mm                | 903 mm                 | 1029 mm                | 1179 mm                |
| Depth                     | 107.8 mm              | 112.7 mm              | 113.7 mm              | 114 mm                 | 105.3 mm               | 124.7 mm               |
| Weight                    | 26 kg                 | 40 kg                 | 58 kg                 | 58 kg                  | 82 kg                  | 110 kg                 |
| Visible screen            | 941mm x 529mm         | 1209.6mm x 680.4mm    | 1428.4 mm x 803.5mm   | 1428.4 mm x 803.5mm    | 1675.8 mm x 928.2mm    | 1929.2 mm x 1078.6mm   |
| <b>Display</b>            |                       |                       |                       |                        |                        |                        |
| Touch points              | 32                    | 32                    | 32                    | 32                     | 32                     | 32                     |
| Screen Type               | LED Backlit           | LED Backlit           | LED Backlit           | LED Backlit            | LED Backlit            | LED Backlit            |
| Aspect ratio              | 16:9                  | 16:9                  | 16:9                  | 16:9                   | 16:9                   | 16:9                   |
| Resolution                | Full HD               | Full HD               | Full HD               | UHD 4K                 | UHD 4K                 | UHD 4K                 |
| Pixels                    | 1920 x 1080           | 1920 x 1080           | 1920 x 1080           | 3,840 x 2,160          | 3,840 x 2,160          | 3,840 x 2,160          |
| Android OS                | ✓                     | ✓                     | ✓                     | ✓                      | ✓                      | ✓                      |
| Brightness                | 300 cd/m <sup>2</sup> | 350 cd/m <sup>2</sup> | 350 cd/m <sup>2</sup> | 350 cd/m <sup>2</sup>  | 450 cd/m <sup>2</sup>  | 350 cd/m <sup>2</sup>  |
| Contrast                  | 1200                  | 1400                  | 4000                  | 4000                   | 4000                   | 1200                   |
| Response Time             | 12ms                  | 8ms                   | 8ms                   | 10ms                   | 8ms                    | 8ms                    |
| Number of Colours         | 16.7M<br>(8-bit)      | 16.7M<br>(8-bit)      | 1.07B<br>(10-bit)     | 16.7B<br>(10-bit)      | 10-bit<br>(8bit + FRC) | 1.07B<br>(10-bit)      |
| Refreshing Frequency      | 60Hz                  | 60Hz                  | 60Hz                  | 120Hz                  | 120Hz                  | 60Hz                   |
| View Angle                | 178/178               | 178/178               | 178/178               | 176/176                | 178/178                | 178/178                |
| Service Life (Minimum)    | > 30,000 hrs          | > 30,000 hrs          | > 30,000 hrs          | > 30,000 hrs           | > 30,000 hrs           | > 30,000 hrs           |
| <b>Power requirements</b> |                       |                       |                       |                        |                        |                        |
| Overall Power Consumption | 120W                  | 230W                  | 260W                  | 270W                   | 500W                   | 550W                   |
| Standby Power Consumption | <=0.5W                | <=0.5W                | <=0.5W                | <=0.5W                 | <=0.5W                 | <=0.5W                 |

| <b>Touch System</b>               |  |
|-----------------------------------|--|
| Sensing Type                      | Infrared System<br>(32 point operation : 65 FHD mode 10 point) |
| Response Time                     | <10ms(typ)   |
| Response Area                     | >=Ø3ms   |
| Reported Touch Resolution         | 32768x32768 (with driver) : 7680x4320 (without driver)         |
| Communication Mode                | USB  |
| <b>Ambient Conditions</b>         |  |
| Operation Temperature             | 0°C-40°C   |
| Operation Humidity                | 10% - 90% RH   |
| Storage Temperature               | -20°C-60°C   |
| Storage Humidity                  | 10% - 90% RH   |
| <b>Main Board Module</b>          |  |
| Main Chipset Manufacture          | MSTAR  |
| <b>Audio</b>                      |  |
| Max Audio Output (THD=7%)         | 15Wx2+20Wx1  |
| <b>Connectivity</b>               |  |
| Composite Video Input (Mini Jack) | 1  |
| Composite Audio Input (Mini Jack) | 3  |
| Component Video input(Mini Jack)  | 0  |
| Component Audio Input (Mini Jack) | 0  |
| S-video Input                     | 0  |
| VGA Input:(D-sub)                 | 3  |

|   |                      |
|---|----------------------|
| VGA Output:(D-sub)                      | 1                    |
| VGA Audio Input                         | 3                    |
| VGA Audio Output (Mini Jack)            | 0                    |
| HDMI Input                              | 2 (Support 4K Input) |
| DP Input                                | 1                    |
| A/V Output (Mini Jack)                  | 0                    |
| Earphone Jack                           | 1                    |
| RS-232C(Type)                           | 1                    |
| SPDIF Output(Optical/ Coaxial)          | 1 (Optical)          |
| USB 2.0                                 | 1 (Side) +2 (Front)  |
| USB 3.0                                 | 2                    |
| USB2.0 for camera For Android & Windows | 1                    |
| LAN(RJ45)                               | 1                    |
| Updating interface                      | USB                  |
| WAN(RJ45)In                             | 1                    |
| WIFI router                             | 1 (A/B/G/N)          |

#### **Supplied Accessories**

AC Power Cable / Operating Instructions / Quick Start Guide / Writing Pen / Remote Control / VGA Cable / USB Cable / HDMI Cable / Guarantee Card

| Andriod OS     |                     |
|----------------|---------------------|
| System Version | Android 5.01        |
| CPU            | ARM Cortex A53 1.5G |
| GPU            | Mali450x4           |
| RAM            | 2GB                 |

| Optional USFF PC integration in rear |   |   |
|--------------------------------------|---|---|
| Processor                            | Intel i5                                | Intel i7                                |
| Graphics                             | Integrated                              | 2GB Dedicated                           |
| Sound Card                           | Integrated High Definition Audio Stereo | Integrated High Definition Audio Stereo |
| Networking                           | Integrated 10/100/1000M Adaption        | Integrated 10/100/1000M Adaption        |
| Memory                               | 4G DDR3                                 | 8GB DDR3                                |
| Hard Drive                           | 500G SATA (SSD option)                  | M.2 128GB SSD                           |
| WIFI                                 | 802.11b/g/n /802.11a/b/g/n (optional)   | 802.11b/g/n /802.11a/b/g/n (optional)   |
| USB(A)                               | 6(4 for USB2.0 2 for USB3.0)            | 6(4 for USB2.0 2 for USB3.0)            |
| Microphone In                        | 1                                       | 1                                       |
| Earphone Out                         | 1                                       | 1                                       |
| HDMI                                 | 1                                       | 1                                       |
| Mini DP                              | 1                                       | 1                                       |
| Lan Port(RJ45)                       | 1                                       | 1                                       |

| Supplied Mounting Bracket |        |         |        |
|---------------------------|--------|---------|--------|
| Width                     | Height | Depth   | Weight |
| 960 mm                    | 240 mm | 29.4 mm | 8kg    |

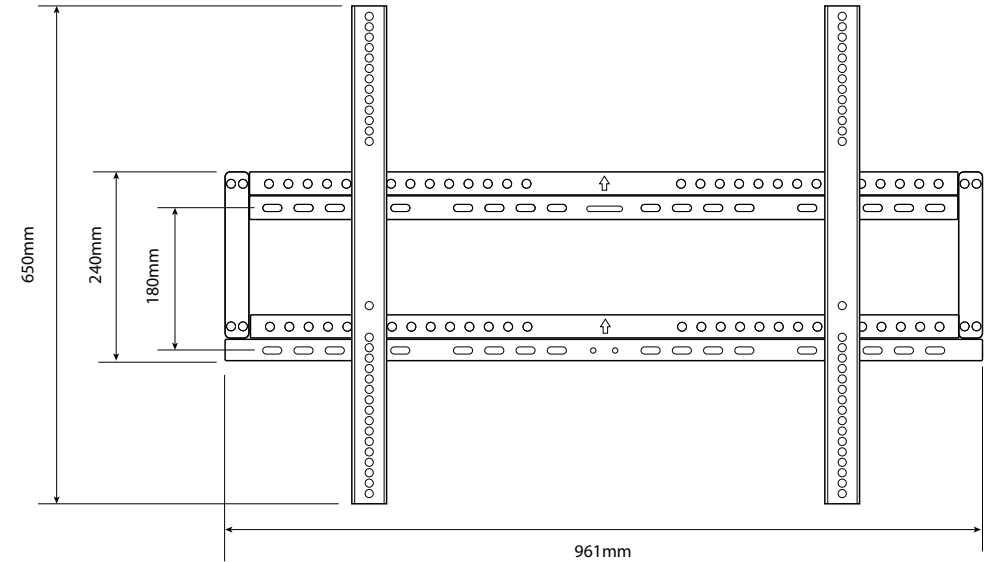

| Packaging |            |                      |                      |
|-----------|------------|----------------------|----------------------|
| Screen    | Net weight | Screen Dimensions    | Packaging Dimensions |
| 43"       | 26kg       | 1015 x 112.2 x 614mm | 1167 x 281 x 784mm   |
| 55"       | 40kg       | 1311 x 113 x 783mm   | 1414 x 232 x 945mm   |
| 65"       | 58kg       | 1527 x 114 x 903mm   | 1664 x 252 x 1072mm  |
| 75"       | 82kg       | 1749 x 105 x 1029mm  | 1871 x 250 x 1166mm  |
| 86"       | 110kg      | 2007 x 110 x 1179mm  | 2200 x 330 x 1380mm  |

# 86" Lightning II Screen

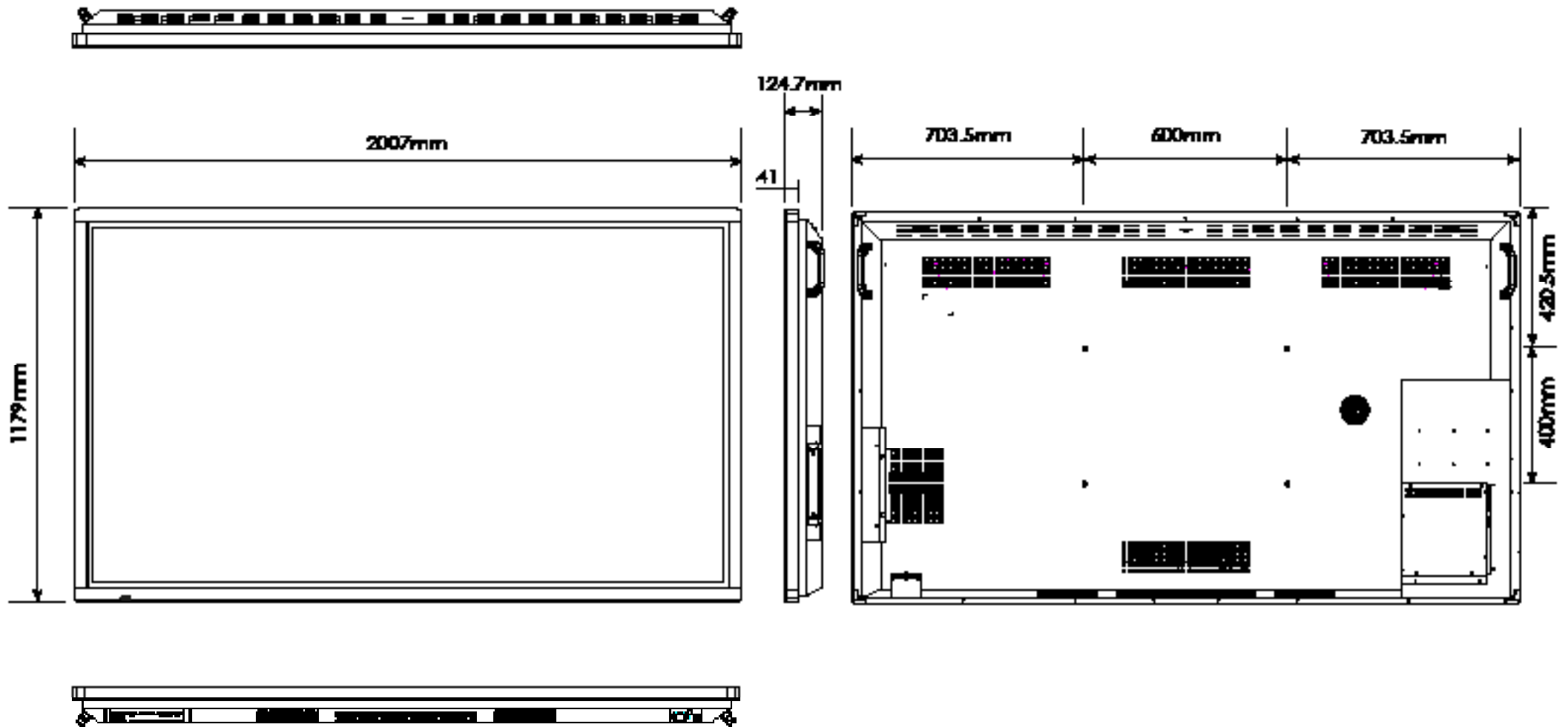

# 75" Lightning II Screen

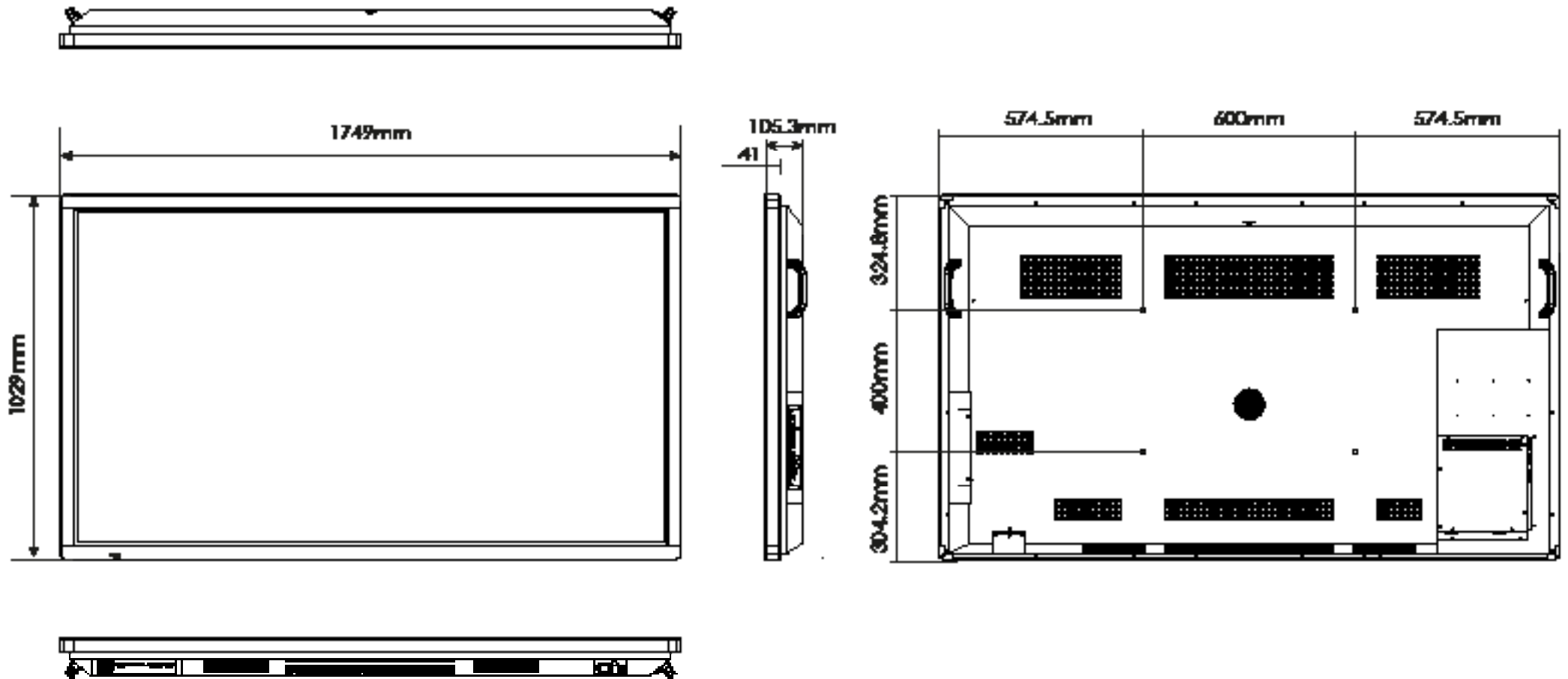

# 65" Lightning II Screen

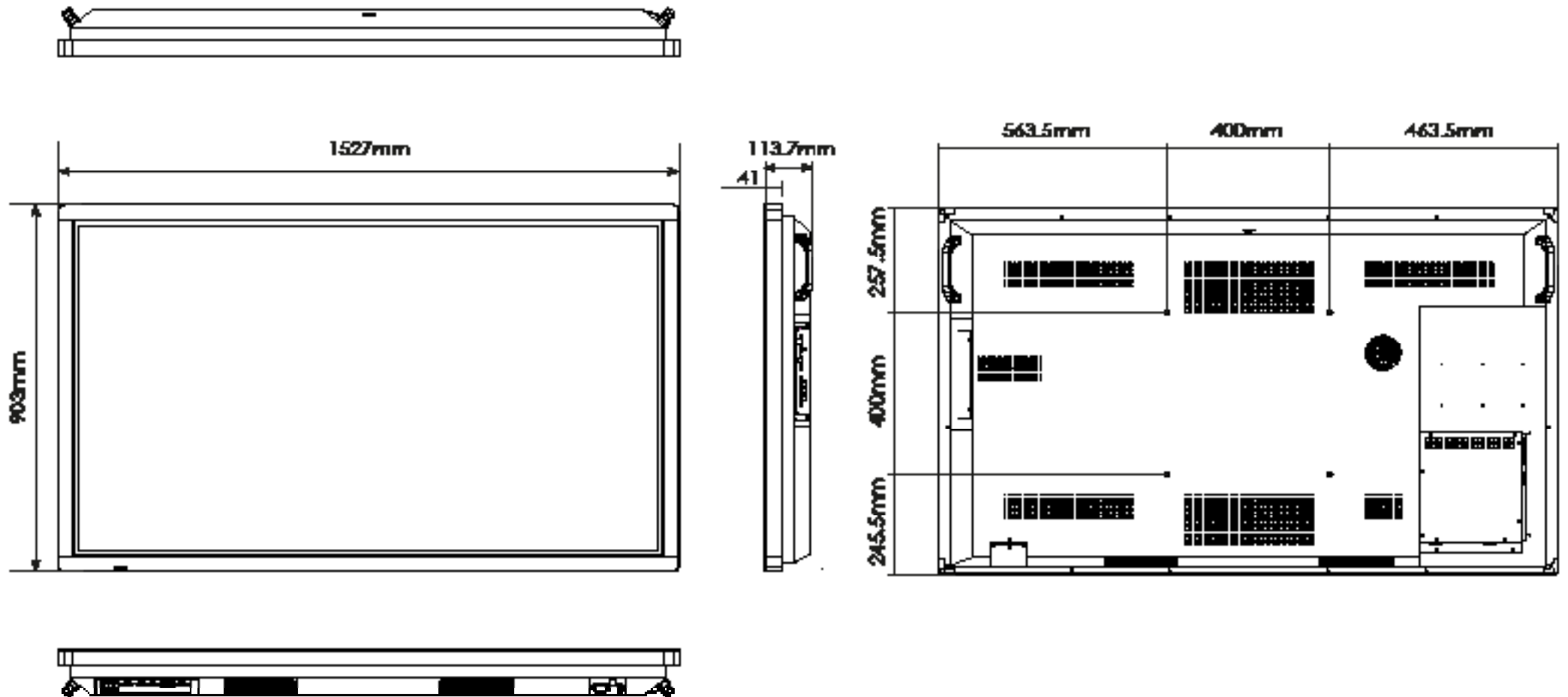



# 55" Lightning II Screen

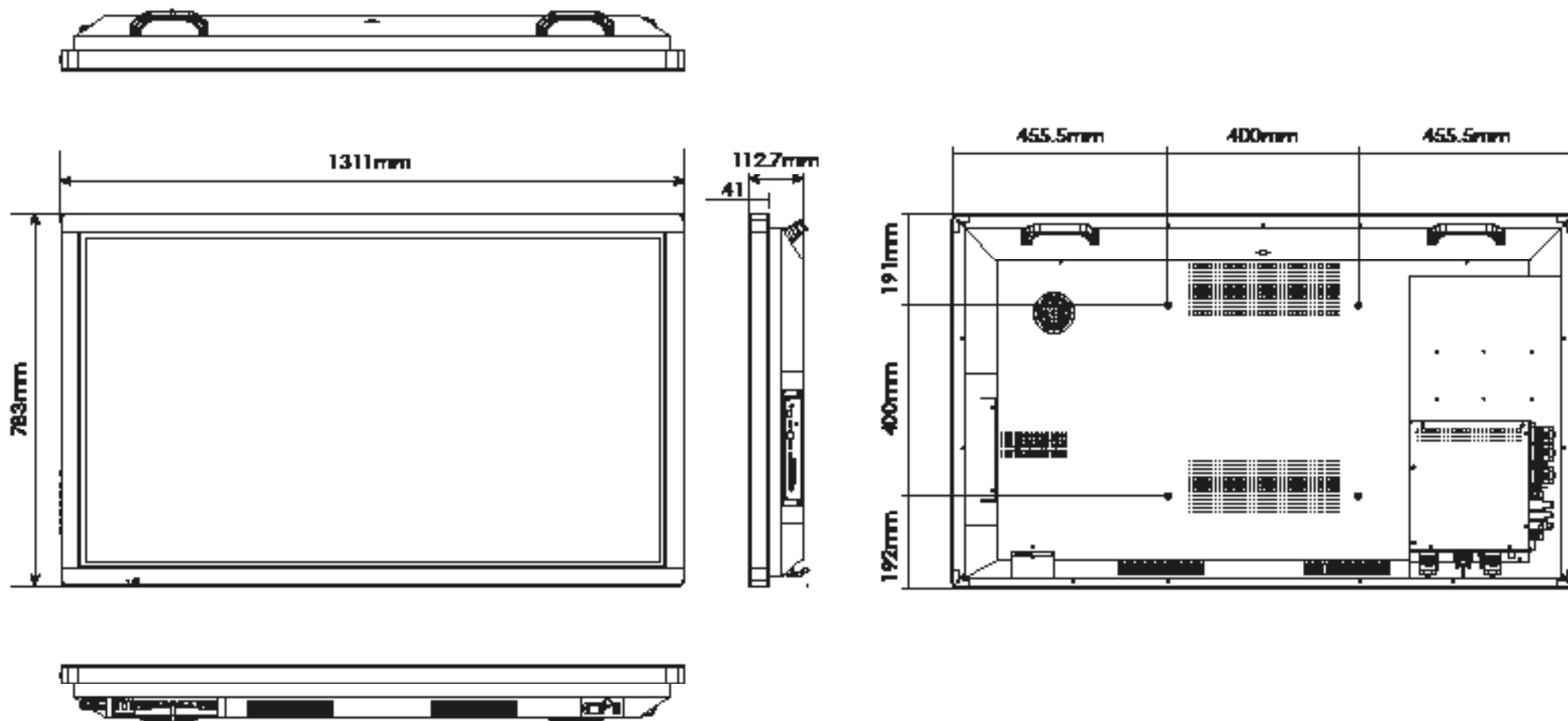

# 43" Lightning II Screen

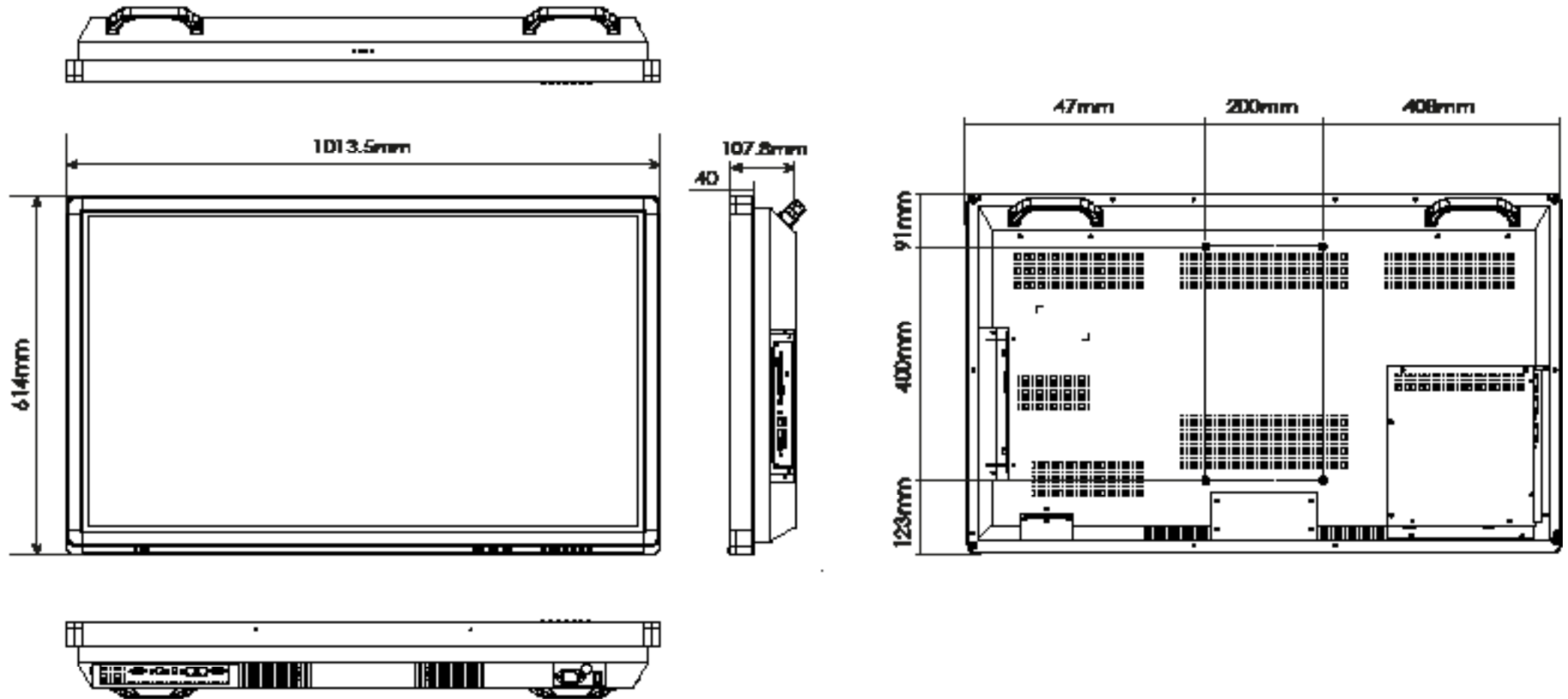



**[promultis]**  
MULTITOUCH SOLUTIONS

For more exciting multitouch products visit  
[www.promultis.info](http://www.promultis.info)  
or call +44 (0) 239 251 2794