



[promultis]

Promultis Video Wall Screens with Projected Capacitive Technology



100 Touch Points with
Projected Capacitive technology



Near seamless single display



Landscape or
portrait orientation



Curved Video Wall Option



Multiple configurations

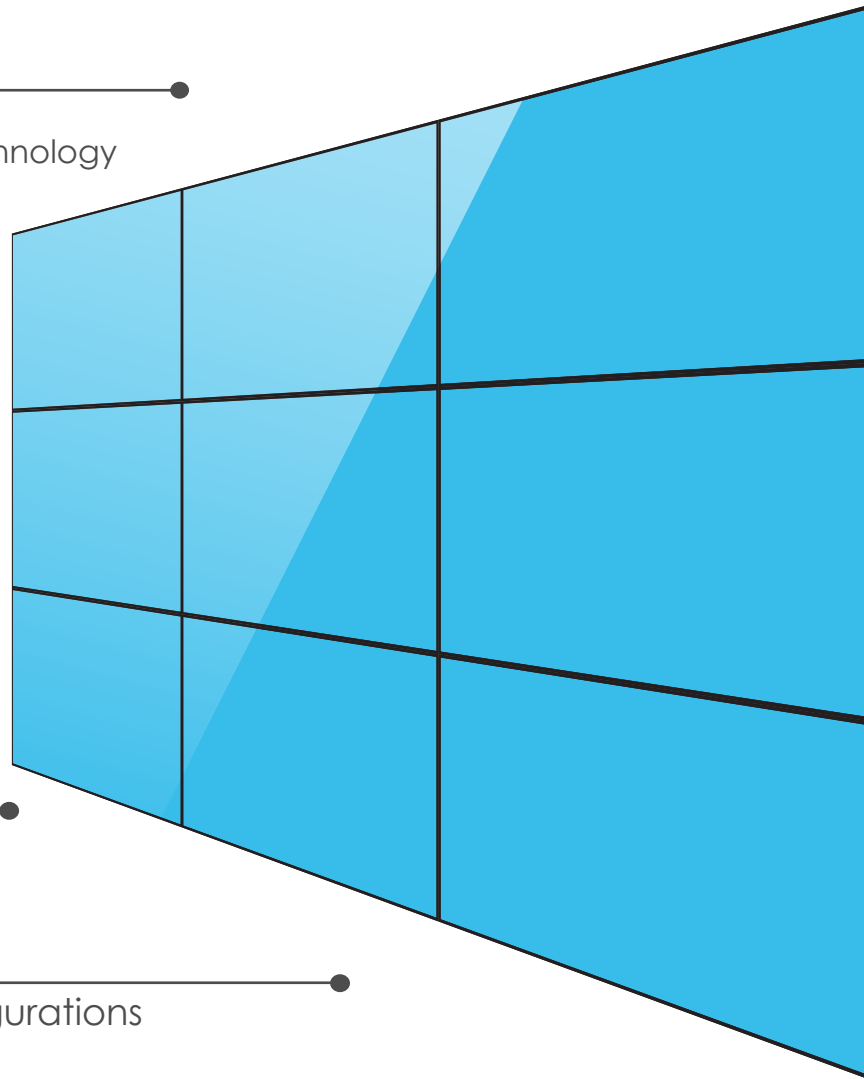

55" 1080p HD LED screens



Tough Anti Scratch



Multiple AV Inputs



1 Year swap-out Warranty



[promultis]
MULTITOUCH SOLUTIONS

For more exciting multitouch products visit
www.promultis.info
or call +44 (0) 239 251 2794

DISPLAY PANEL	
Screen size	55 inch
Panel tyoe	LED
Aspect ratio	16:9
Interactive area	1211pixels x 682 pixels
Panel resolution	1080p HD
Native resolution	1920 x 1080
Brightness (nits)	700 cd/m²
Dynamic constrast	1300 to 1
Contrast ratio	50000 to 1
Response time	8ms
Aspect ratio	16x9
Viewing angle	178° / 178°
Pixel pitch	0.744 (mm)
LCD Illumination	Backlit LED
Speaker	10W x2
GLASS	
Type	Tempered glass
Thickness	5mm
Anti-glare	80%
Finish	Glass chamfered, perfectly polished sides
UNIT	
Dimensions	1227mm (W) x 698mm (H) x 57mm (D)
Weight	approx 32 kg
Bezel width	8mm
Bezel colour	Black
Pitch for wall mounting	ESA compliant 400 x 400 mm
WARRANTY	
1 year on-site warranty as standard	
Extended warranties and SLA's available at an additional cost	

CONNECTION	
HDMI	HDMI Type A Connector x 2
Component/RGB IN	BNC x1 set
Audio In	Stereo Mini Jack (M3) x 1
Video In	BNC x 1
Audio In	Stereo Mini Jack (M3)
DVI-D In	DVI-D 24-pin x 1
AUDIO In	Stereo Mini Jack (M3) x 1
DVI-D Out	DVI-D 24-pin x 1
PC In	Mini D-Sub 15-pin x 1 (Female)
Audio In	Stereo Mini Jack (M3) x 1
Serial In/Out	D-sub 9pin x 1 / x1, RS-232C compatible
LAN/Digital Link In	RJ45 x 1 100Base-TX, compatible with PLink
IR Transmitter In /Out	Stereo Mini Jack (M3) x 1 / x 1
Audio Out	Stereo Mini Jack (M3) x 1 / x 1
USB	USB 2.0 Type A connector x 1 DC 5 V / 1A
POWER REQUIREMENTS	
Power requirements	220-240 V AC 50 / 60 Hz
Power Consumption	190 W
On Mode Average Power Consumption	145 W
Power Off	approx. 0.3 W
Stand-by condition	approx. 0.5 W
ENVIRONMENTAL	
Operating temperature	
Temperature	0°C to 40 ° : 0° to 35°
Humidity	20% to 80% (No condensation)
Altitude	0 to 2800 m
Storage Environment	
Temperature	-20 °C to 60 °C
Humidity	20% to 80% (No condensation)

PROJECTED CAPACITIVE	
Detection method	Projected Capacitive
Input method	Finger and gloved finger
Number of simultaneous touches	100
Noise Shielding	DISPLAX XTR-Shield™ Plus, a proprietary noise filtering technology
Aspect ratio	16:9
Controller	Printed circuit board with mini USB connector
Adhesive	Permanent
Interface	HID
OS with multitouch	Windows 8.1, 8, 7, 10; Ubuntu 12.04; Android; Chrome OS
OS with single touch	Mac OS X Yosemite
OS with mouse emulation	Spinetix Media Player HMP 200, Samsung SSP D Series
Data connectivity	USB 2.0
Touch accuracy	0,26% of sensor diagonal
PERFORMANCE	
Touch response	5 milliseconds
Calibration	Available using control panel: no drift
POWER CONSUMPTION	
Average power consumption (P)	USB powered @ 5V
	Peak consumption: 410 mA
	Operation consumption: 370mA
RELIABILITY	
Operating temperature range	-20°C to 70°C
Operating humidity range	0% to 96%
Life time expectancy	Unlimited
Controller life time expectancy	1 million hours

Connectivity





[promultis]

Promultis Video Wall Screen with projected capacitive technology

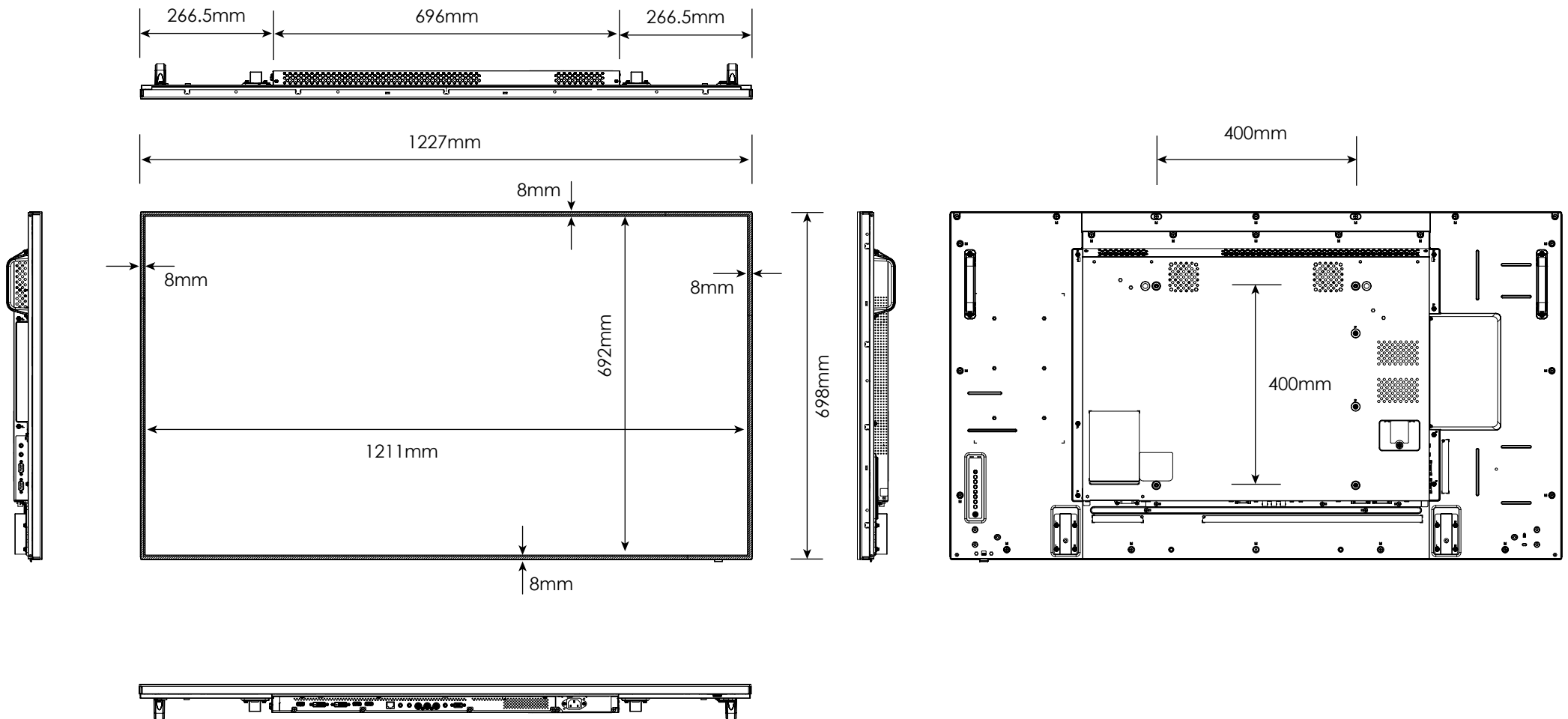

[promultis]
MULTITOUCH SOLUTIONS

For more exciting multitouch products visit
www.promultis.info
or call +44 (0) 239 251 2794